

- Flexible
- Próximo
- Fiable
- Rentable

**SERIE**  
**C94**

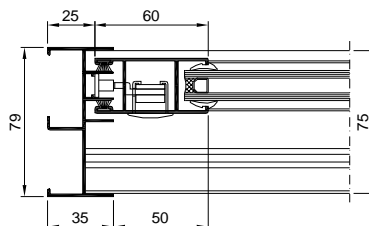

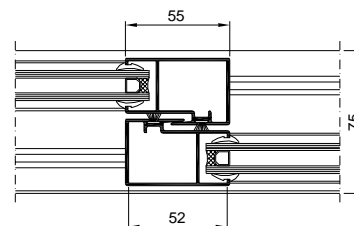
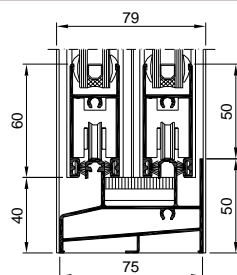
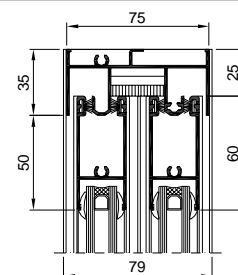
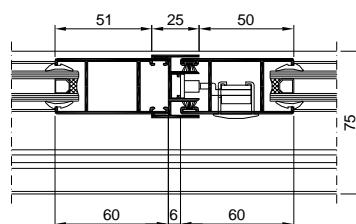
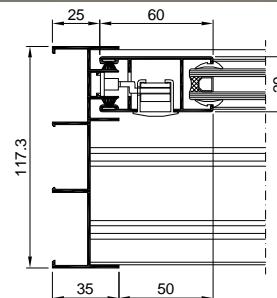
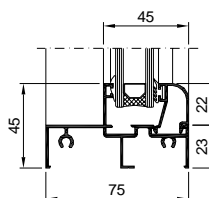
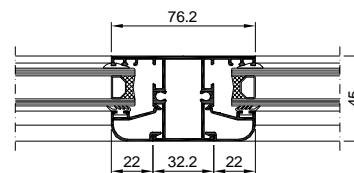

**1 Marco Lateral**

**2 Nudo Central**

**3 Marco Inferior**

**4 Marco Superior**

**5 Cierre Central**

**6 Marco Fijo**

**7 Marco Lateral - Abatible**

**8 Marco Lateral - Fijo**

## Descripción

- Carpintería corredera de corte recto.
- Marco de 75 mm. y hojas de 29 mm.
- Espesor medio en marcos y hojas de 1,5 mm.
- Juntas de estanqueidad mediante burletes.
- Hueco de acristalamiento entre 10 y 22 mm.

## Ensayos Marcado CE

Medidas de ensayo: 1,23 x 1,48 m. = 1,82 m<sup>2</sup>

**AIRE** 3

**AGUA** 4A

**VIENTO** C5

**TÉRMICA**  $U_w = 3,1 \text{ W / m}^2$

**ACÚSTICA**  $R_w = 29 \text{ (-1;-3) dBA}$

Transmitancia Térmica calculada para carpintería de 5,51 m<sup>2</sup> con vidrio bajo emisivo 4/16/4

Atenuación Acústica calculada para carpintería con una superficie inferior a 3,10 m<sup>2</sup>

## Aperturas

Ventanas y Puertas Balconeras



2 HOJAS

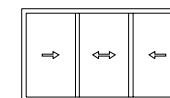

3 HOJAS

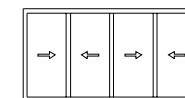

4 HOJAS

Otras Combinaciones

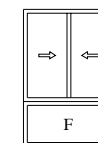

2 HOJAS - FIJO

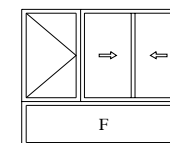

2 HOJAS - ABATIBLE - FIJO

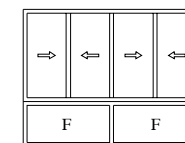

4 HOJAS - FIJOS

M-2206

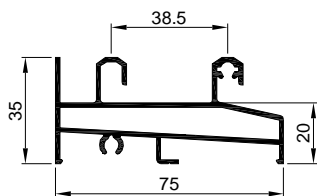

M-2859

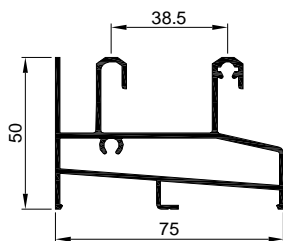

M-2153

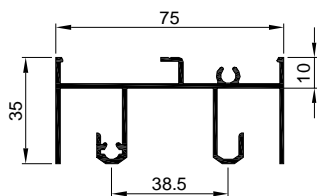

M-2151

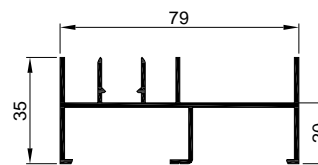

M-2486

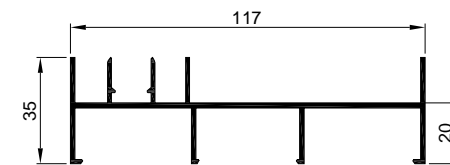

M-2750

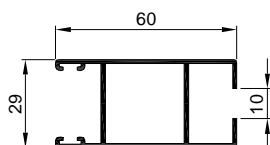

M-2154

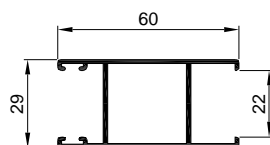

M-2160

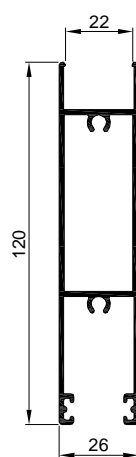

M-2161

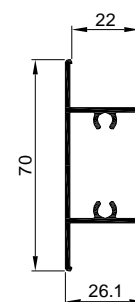

M-2487

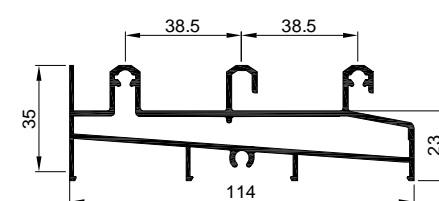

M-2751

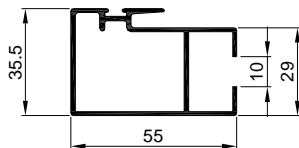

M-2155

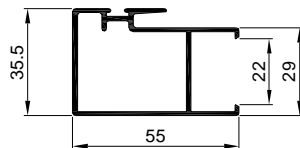

M-2488

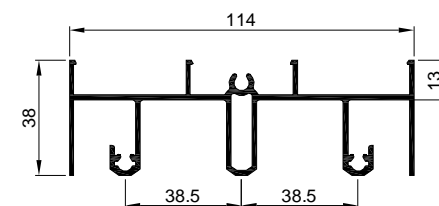

M-2752

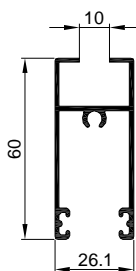

M-2156

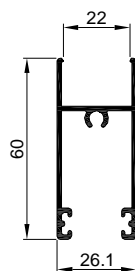

M-2157

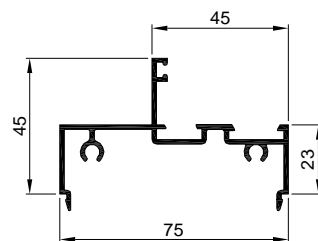

M-2158

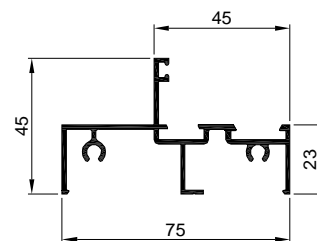

M-2162

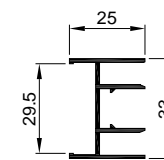

M-2163

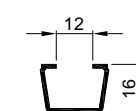

M-2990

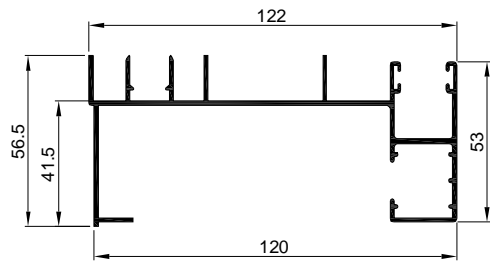

M-2991

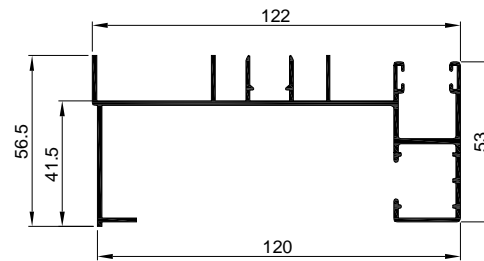

M-3204

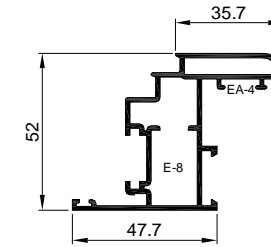

M-1997

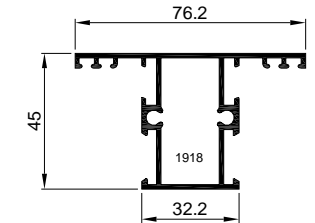

M-3393

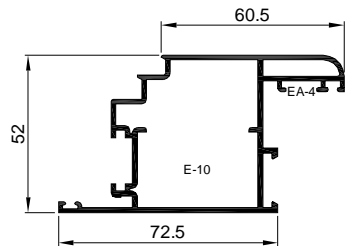

M-1999

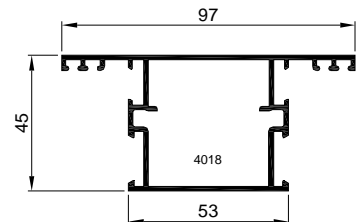

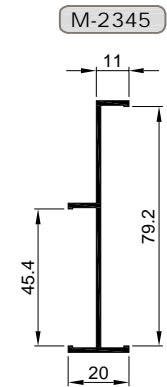
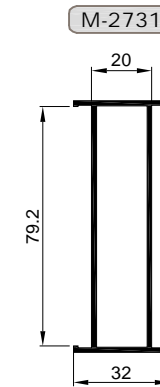
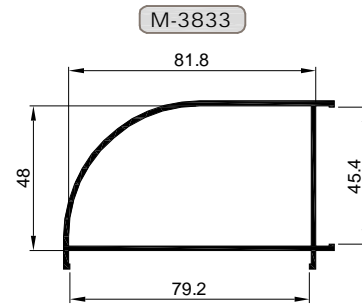
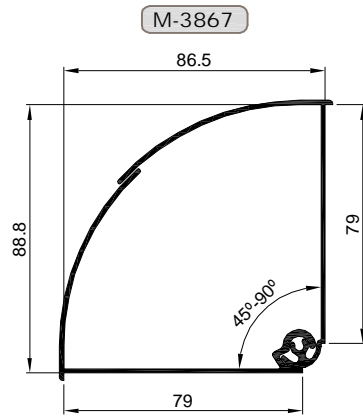
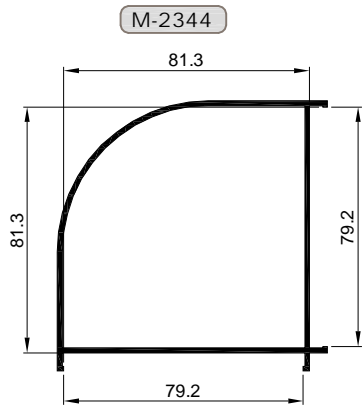

M-3868

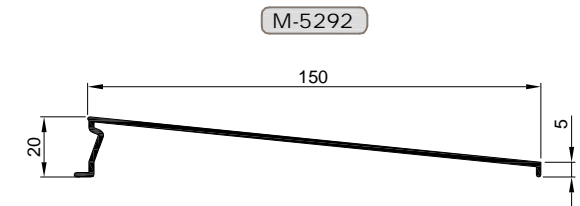
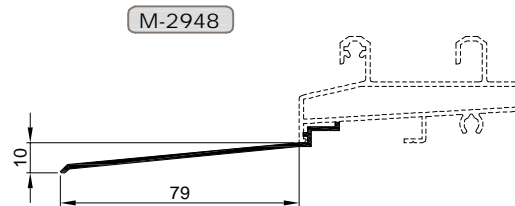
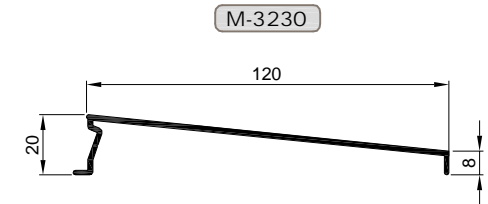
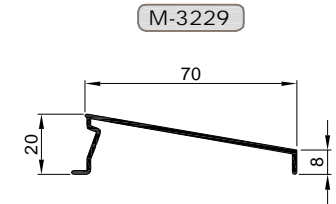
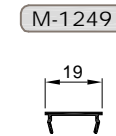
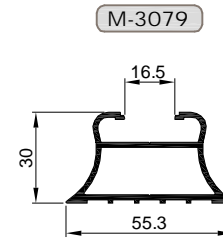
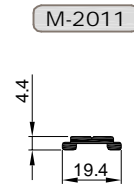
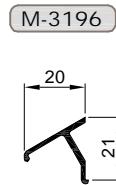

CON TORNILLO 6 CLIP

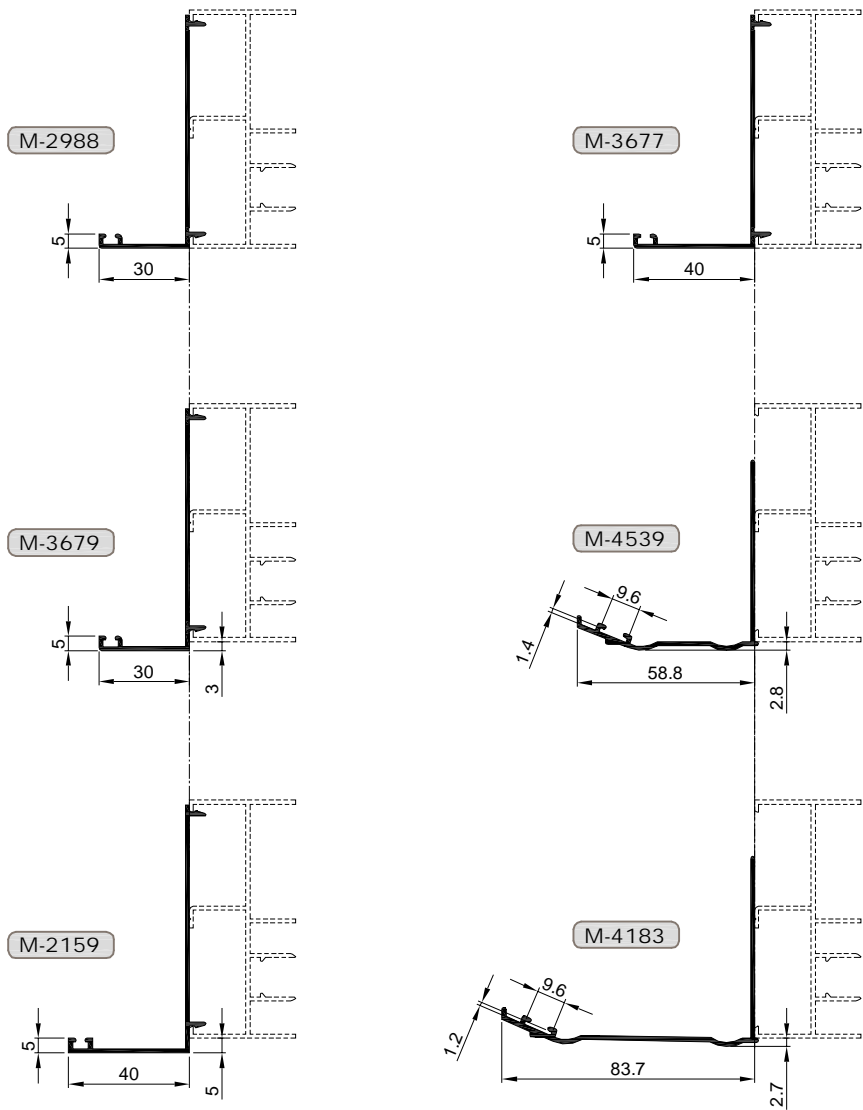

CON GRAPA

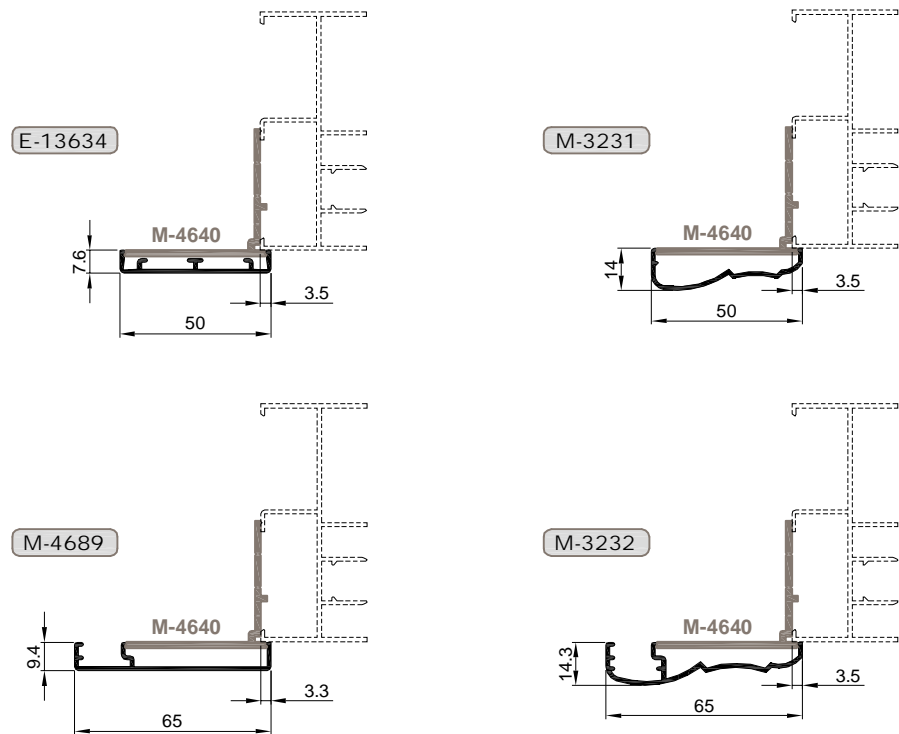



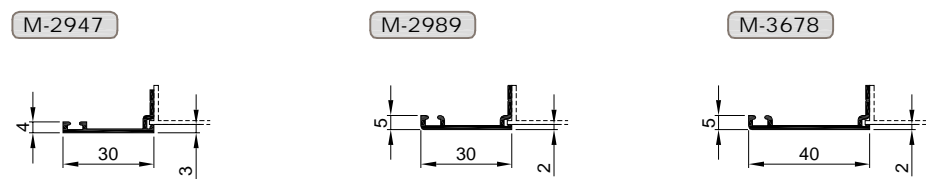

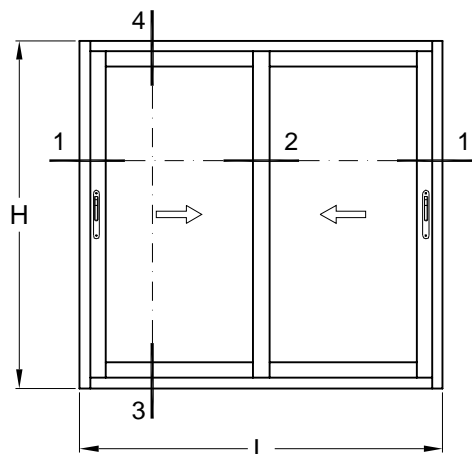

MONOBLOCK

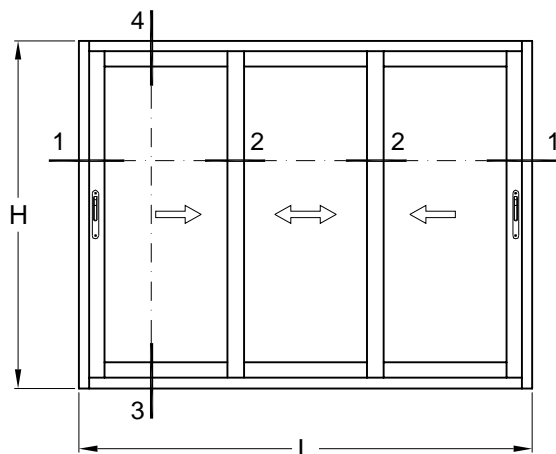
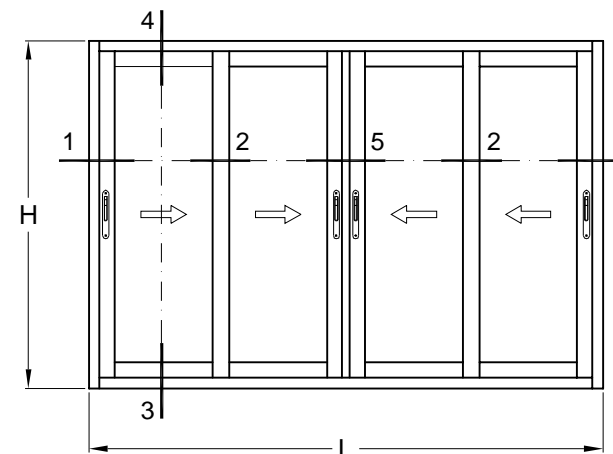

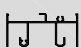
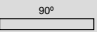
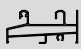
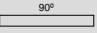
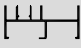

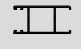



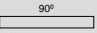

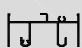
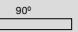
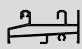
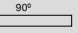
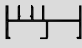

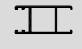



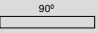

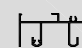
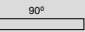
**CORREDERA DE 2 HOJAS**

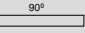
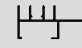
**CORREDERA DE 3 HOJAS**

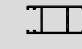
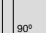
\* VIDRIOS IGUALES

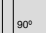
**CORREDERA DE 4 HOJAS**

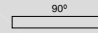
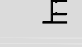
PERFIL	Refª. / DENOMINACION	Uds. / Corte			
	<b>M-2153</b> MARCO SUPERIOR	1	L - 40		
	<b>M-2206</b> MARCO INFERIOR	1	L - 40		
	<b>M-2151</b> MARCO LATERAL	2	H		
	<b>M-2154</b> HOJA LATERAL	2	H - 51		
	<b>M-2155</b> HOJA CENTRAL	2	H - 51		
	<b>M-2156</b> HOJA RUEDAS	4	L / 2 - 16		

PERFIL	Refª. / DENOMINACION	Uds. / Corte			
	<b>M-2153</b> MARCO SUPERIOR	1	L - 40		
	<b>M-2206</b> MARCO INFERIOR	1	L - 40		
	<b>M-2151</b> MARCO LATERAL	2	H		
	<b>M-2154</b> HOJA LATERAL	2	H - 51		
	<b>M-2155</b> HOJA CENTRAL	6	H - 51		
	<b>M-2156</b> HOJA RUEDAS	4	L / 3 + 3		
		2	L / 3 + 13		

PERFIL	Refª. / DENOMINACION	Uds. / Corte			
	<b>M-2153</b> MARCO SUPERIOR	1	L - 40		
	<b>M-2206</b> MARCO INFERIOR	1	L - 40		
	<b>M-2151</b> MARCO LATERAL	2	H		
	<b>M-2154</b> HOJA LATERAL	4	H - 51		
	<b>M-2155</b> HOJA CENTRAL	4	H - 51		
	<b>M-2156</b> HOJA RUEDAS	8	L / 4 - 5		
	<b>M-2162</b> CIERRE CENTRAL	1	H - 51		

- Las medidas indicadas son orientativas. Rogamos verifiquen las mismas antes de cortar material en serie para evitar posibles errores.



Sección 1 - 1

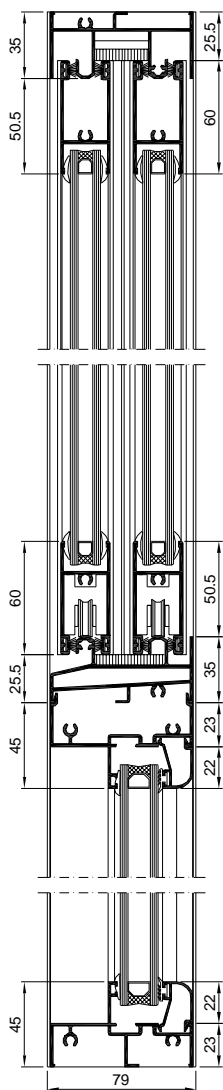

**CORREDERA DE 2 HOJAS  
Y FIJO INFERIOR**

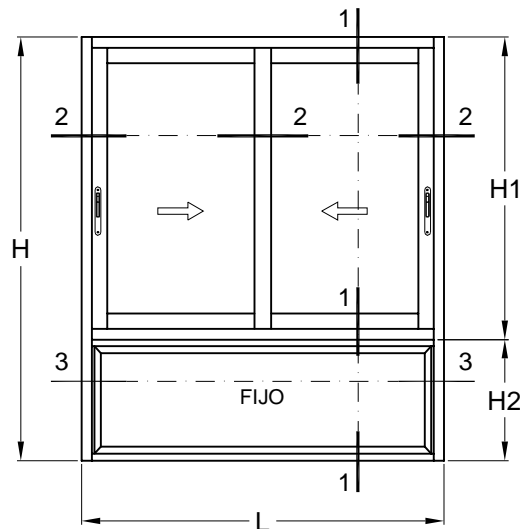

Sección 2 - 2

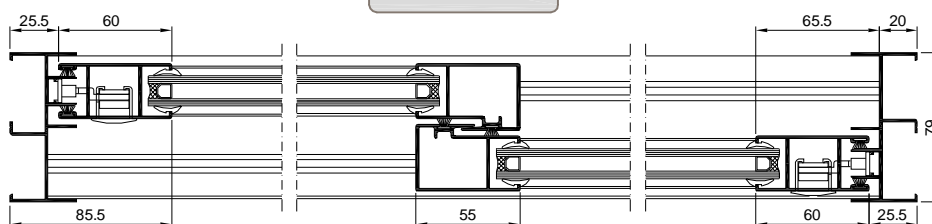

Sección 3 - 3

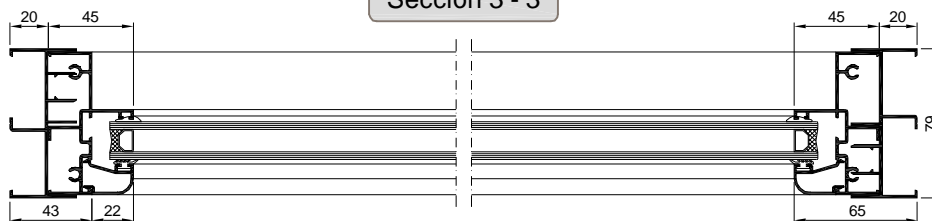

PERFIL	Refª. / DENOMINACION		Uds. / Corte		
	M-2153	MARCO SUPERIOR	1	L - 40	
	M-2206	MARCO INFERIOR	1	L - 40	
	M-2151	MARCO LATERAL	2	H	
	M-2154	HOJA LATERAL	2	H1 - 51	
	M-2155	HOJA CENTRAL	2	H1 - 51	
	M-2156	HOJA RUEDAS	4	L / 2 - 16	
	M-2157	MARCO FIJO CLIP	1	L - 40	
	M-2158	MARCO FIJO	1 2	L - 40 H2 - 46	
	Ver Tabla	JUNQUILLOS	2 2	L - 86 H2 - 46	

- Las medidas indicadas son orientativas. Rogamos verifiquen las mismas antes de cortar material en serie para evitar posibles errores.

EN PREPARACION



c/ Cormoranes, 18 Poligono Industrial La Estación  
28320 - Pinto ( MADRID )  
Telf: 91 691 54 11 / Fax: 91 691 58 79  
E-mail: [extrusion.spain@sapagroup.com](mailto:extrusion.spain@sapagroup.com)

SAPA y SISTEMAS EXPRAL como marca de SAPAGROUP no se hacen responsables del mal uso que se realice de los contenidos de este catalogo, siendo exclusiva responsabilidad de la persona/as que accede a ellos o los utiliza.

Tampoco asumimos ninguna responsabilidad de los errores tipográficos que puedan aparecer en este catálogo y nos reservamos el derecho de cambiar o modificar sin previo aviso su contenido cuando sea necesario.